



HEALTH CONNECT PARTNERS

# HOSPITAL PHARMACY

CONFERENCE | FALL 13



# CardinalHealth

*Essential to care™*

*“Remote order entry gives us improved patient safety. That’s really what we were looking for.”*

Sondra Donald, Director of Pharmacy,  
Boone County Hospital

## Innovative Delivery Solutions Improve quality. Increase operational efficiency.



Medication safety will always be your top priority. With the Cardinal Health *R<sub>x</sub>e-source*<sup>™</sup> Remote Order Entry Service, you can ensure that every medication order is thoroughly reviewed by a hospital-trained pharmacist — any time, day or night. Prospective pharmacist review not only ensures continuity of care and operational efficiency, it also lets you spend more time with the people who matter most — your patients.

From the pioneers in remote order entry

Cardinal Health pioneered remote pharmacy services in 2003. Since then, we’ve been helping hospitals all over the country elevate their standard of care. Our pharmacists work from licensed pharmacy service centers across the country to ensure HIPAA compliance, support clinical collaboration and ensure availability through facility and technology redundancy.

Effective for patients and efficient for you

- Standardized tracking and reporting on productivity, quality and clinical metrics
- 20–30 percent less than the cost of hiring staff
- Turn-around time on orders is less than 20 minutes on average



Free up your pharmacists to  
**focus on patients**  
and reduce errors



**CardinalHealth**  
*Essential to care*<sup>™</sup>

[cardinalhealth.com/rxe-source](http://cardinalhealth.com/rxe-source)

Cardinal Health  
7000 Cardinal Place  
Dublin, Ohio 43017

877.300.9180

# WELCOME



**W**elcome to Los Angeles and our 2013 Fall Hospital Pharmacy Conference! We are so glad that you are able to join us. Special thanks to Cardinal Health, our title sponsor. Their continued support is invaluable to the success of this event.

We are excited to continue our Supplier Showcases, open on Monday only from 12:00 noon – 4:00 PM in the San Diego Ballroom. This opportunity will give a few select supplier companies the chance to share their products, services and technology before the Reverse EXPO. Stop by to check it out – and if you are interested in having a showcase of your own next year, stop by the HCP table inside the Supplier Showcase to let us know.

As always, this conference features two Reverse EXPO sessions, sponsored by CareFusion, to help build relationships between providers and suppliers. During the Reverse EXPO sessions, the Pharmacy Directors and GPO Executives will host the booths while the suppliers walk through the expo hall. This unique event is a fun change of pace from traditional expo formats and provides the best networking opportunity for both providers and suppliers.

Over the next few days, our conference will provide you with numerous networking opportunities as well as educational sessions led by some of the top healthcare executives and speakers in the nation. Topics include “2013 C-Suite Agenda,” “Pharmacy Practice Model Initiative: Transforming Pharmacy Practice,” and “The Future of the Hospital Pharmacy.” We are also proud to present Mark Scharenbroich as our keynote speaker for an unforgettable session entitled “Nice Bike - Making Connections That Move People.”

We hope you find this conference to be informative and useful in helping you make the connection. If you need assistance at any time, please stop by the registration desk and we will be happy to help however we can.

Sincerely,

Jason Green  
Chief Sales Officer

*Title Sponsor*



# HEALTH CONNECT PARTNERS



**JASON GREEN**  
Chief Sales Officer  
Hilton Head, SC

Jason Green holds the post of Chief Sales Officer for Health Connect Partners. He has extensive experience in the healthcare industry, working in both large corporate environments and small start-up healthcare organizations. Jason's ability to relate to customers and colleagues has allowed him to foster many long-term relationships throughout the healthcare industry.

Jason and his wife, Dana, have two children, Max (10) and Ella Kate (3), who keep him dedicated to a busy social calendar. Max is focused on his golf game. He competed in the US Kids World Golf Tournament this summer in Pinehurst, NC. A learning experience for the entire family. Dad quickly realized that a caddie has no say in club selection. We have an exciting tour planned in 2014, with an invitation to play Innisbrook Golf Resort in Tampa, FL in early January. Ella Kate is involved with soccer, gymnastics, dance and anything that is music related. She loves to sing and can often be found with a microphone in her hand and dancing to the newest songs. During the

break in activity, Jason's golf game gets his attention. He was able to card his lowest nine hole score of 33 this summer followed by a back nine of 48. Jason is a graduate of Ohio University. He continues to support the Ohio State Buckeyes, Pittsburgh Steelers and Boston Red Sox and is a true Pittsburgh Penguins fan.

David Mason is Co-Founder and CEO of HCP. Prior to founding HCP, he was Founder and President of BCX Technology, Inc., a software automation company specializing in supply automation for acute care hospitals. He led the BCX team for eight years and sold the company in 2003 to Omnicell.

David and his wife, Tammy, have two wonderful children, Alexis (20) and Madison (13). An avid boater, he spends his time boating with his family, diving, lobster hunting, running, swimming and cycling. This past winter David got to mark something off his bucket list and rode a bobsled on the 2002 Olympic Bobsled Track where he reached speeds of about 80 mph, and experienced up to 5 Gs of force. This past August, David did something just as exciting (if not more), when he walked his little girl down the aisle. Alexis and Zac Morgan got married in Nashville, TN on August 10th, and David and Tammy could not be more excited to welcome Zac into their family. David is a graduate of Nashville State Technical Institute, Chairman of the Board for BCX Foundation (a nonprofit educational foundation for children), a Black Belt in Wado Ryu Karate and an Eagle Scout.



**DAVID MASON**  
Chief Executive Officer  
Lebanon, TN

Nelson Hendry, Co-Founder and President, works with the Providers and sales team at HCP. Prior to founding HCP, he served as Regional Vice President of Corporate Sales for Omnicell, working with large IDN Health Systems and the major GPOs. He was awarded the 2005 Salesman of the Year Award for Omnicell's Specialty Sales. Nelson graduated with a Bachelor of Science degree from Florida State University in 1981.

Nelson and his wife, Evelyn, have three boys. Joseph (25) is a video game artist in the X-Box Division at Microsoft and enjoys weight lifting in his spare time. Justin (23) is a graduate of M.I.T. in Cambridge, MA with a degree in Mechanical Engineering. He is employed in Business Development with a Texas based Healthcare Company. Taylor (10) is in the fifth grade in the gifted program at Brooker Creek Elementary and loves playing flag football, video games, Minecraft, Lacrosse and soccer.



**NELSON HENDRY**  
President  
Palm Harbor, FL

# Sodium Phenylbutyrate Powder

*The first and only FDA approved generic product in the market  
AB-rated equivalent and directly substitutable to Buphenyl® Powder*



Sigmapharm Laboratories is a U.S. company based and operating out of Bensalem, Pennsylvania. We own or control more than 80 domestic and international patents and patent applications. All of our products are made and tested in the USA, in our FDA inspected and approved state-of-the-art facilities.

## Sodium Phenylbutyrate Powder AB Rated to Buphenyl®\*

NDC	STRENGTH	SIZE
42794-086-14	3GM/TEASPOONFUL	250 GRAMS

\* Buphenyl® is a registered trademark of Ucyclid Pharma, Inc.

24 Months Shelf Life (Expiration Dating)



*Innovative Pharmaceutical Technologies Maximizing Drug Therapy*

*We develop and manufacture products that most others cannot*

## [www.sigmapharm.com](http://www.sigmapharm.com)

Grace Wilks Director, Sales & Marketing Contact: [gwilks@sigmapharm.com](mailto:gwilks@sigmapharm.com) or 215.352.6628

Aphrodite Kotrotsios Account Manager, Sales & Marketing Contact: [akotrotsios@sigmapharm.com](mailto:akotrotsios@sigmapharm.com) or 215.352.6632

**1 ONE UNIT  
ONE DOSE  
ONE AND ONLY**



**HURRICAINE  
ONE®**

Unit Dose Non-Aerosol Spray  
20% Benzocaine Oral Anesthetic  
0.5 mL each  
**ORIGINAL WILD CHERRY FLAVOR**

## An Innovative Non-Aerosol Unit Dose Topical Anesthetic Spray

- Meets Joint Commission Standard for the most ready-to-administer form available.\*
- Fast onset. Short duration. Virtually no systemic absorption.
- Utilizes bar code medication administration (BCMA) to accommodate point-of-care scanning.
- Virtually eliminates adverse events resulting from preventable medication errors, ensuring the "5 Rights" are met: ✓ Right Drug ✓ Right Patient ✓ Right Dose ✓ Right Route ✓ Right Time
- Single unit-of-use packaging eliminates the potential for cross-contamination.
- Increases billing accuracy and improves supply chain costs.

### ORDERING INFORMATION

NDC#	AMERISOURCE BERGEN	CARDINAL HEALTH	MCKESSON	MORRIS & DICKSON	PRODUCT
0283-0610-11	048-855	CIN 4362547	1410125	086611	HurriCaine ONE® Unit Dose Non-Aerosol Spray Box of 2, 0.017 fl. oz. (0.5 mL) each
0283-0610-26	048-868	CIN 4363370	1411925	086629	HurriCaine ONE Unit Dose Non-Aerosol Spray Box of 25, 0.017 fl. oz. (0.5 mL) each

If HurriCaine ONE is not yet available through your wholesaler, request it by name and NDC Number.

\*Joint Commission Standard: MM.05.01.11, EP4



**MAKE THE SWITCH TODAY.**

Call 1-800-238-8542 to place your order or for more information. [www.beutlich.com](http://www.beutlich.com)

HurriCaine ONE is a registered trademark of Beutlich® Pharmaceuticals, LLC. HCOA 650 0713B

# AGENDA AT A GLANCE



## MONDAY OCTOBER 14

11:00 am - 8:00 pm:	Supplier Registration	Registration Desk - Level 2
11:30 am - 4:00 pm:	Provider Registration	San Jose - Level 2
12:00 pm - 4:00 pm:	Supplier Showcase	San Diego - Level 2
4:15 pm - 5:30 pm:	Provider Orientation Meeting	California Ballroom - Level 2
5:30 pm - 6:15 pm:	Provider Dinner	Catalina Ballroom - Level 3
6:30 pm - 7:30 pm:	Welcome Reception	Plaza Deck* - Level 4
7:30 pm - . . .	Hospitality Suites	Lobby Level, Level 3 & 31 <sup>st</sup> Floor

## TUESDAY OCTOBER 15

7:00 am - 6:00 pm:	Registration Desk Open	Registration Desk - Level 2
7:00 am - 8:00 am:	Breakfast	San Diego - Level 2
8:00 am - 9:30 am:	Opening Remarks & Keynote Address	California Ballroom - Level 2
9:30 am - 9:45 am:	Coffee Break	California Prefunction - Level 2
9:45 am - 11:45 am:	Educational Session	California Ballroom - Level 2
11:15 am - 1:00 pm:	Lunch	Plaza Deck* - Level 4
1:00 pm - 2:30 pm:	Educational Session	California Ballroom - Level 2
3:00 pm - 5:00 pm:	Reverse EXPO Session 1	Pasadena Room - Lower Level
6:00 pm - 10:00 pm:	Dinner & Entertainment	The Belasco Theater

*Shuttles will run continuously between the Westin Bonaventure and The Belasco Theater from 5:45 pm - 10:00 pm.*

## WEDNESDAY OCTOBER 16

6:45 am - 12 noon:	Registration Desk Open	Registration Desk - Level 2
6:45 am - 7:45 am:	Breakfast	California Ballroom - Level 2
8:00 am - 10:00 am:	Reverse EXPO Session 2	Pasadena Room - Lower Level
10:30 am - 11:30 am:	Educational Session	California Ballroom - Level 2

*Most conference events take place near the Yellow and Red elevator towers. Levels 2, 4 and the Lower Level do not have elevator access.*

*\*Rain backup in the California Ballroom.*

# WESTIN BONAVENTURE



## Lower Level



## Lobby Level



## Level 2

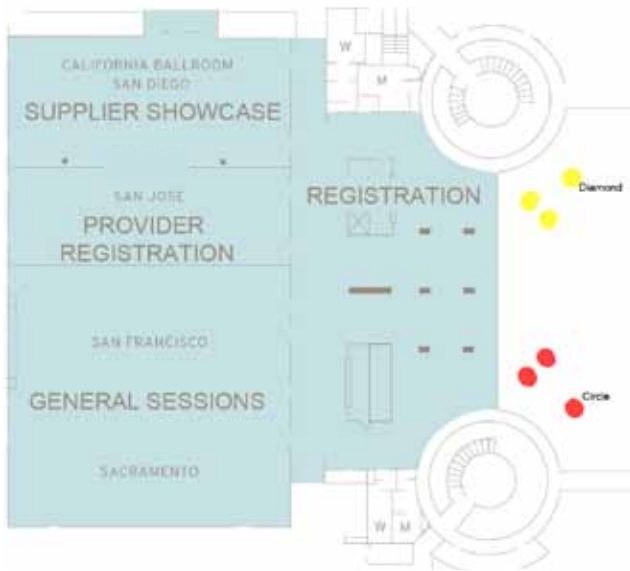

## Level 3

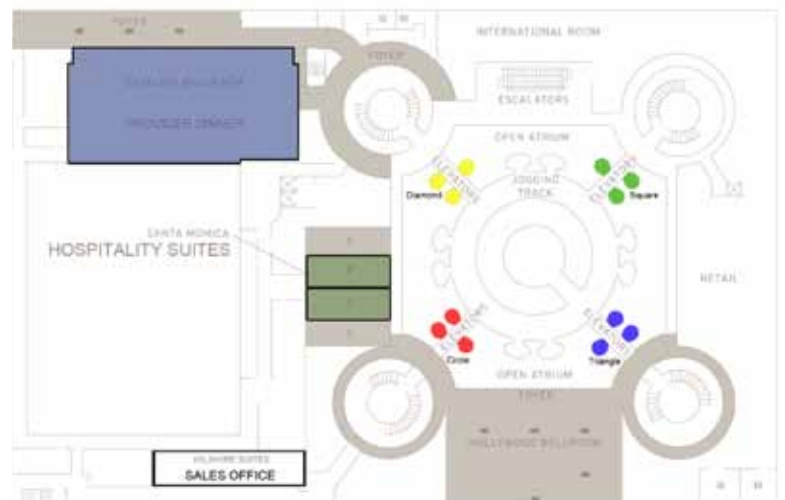

*Most conference events take place near the Yellow and Red elevator towers. Levels 2, 4 and the Lower Level do not have elevator access.*

Nursing frustrated as they waste time tracking medication deliveries.

Controlled substances and IVs are untracked during delivery.

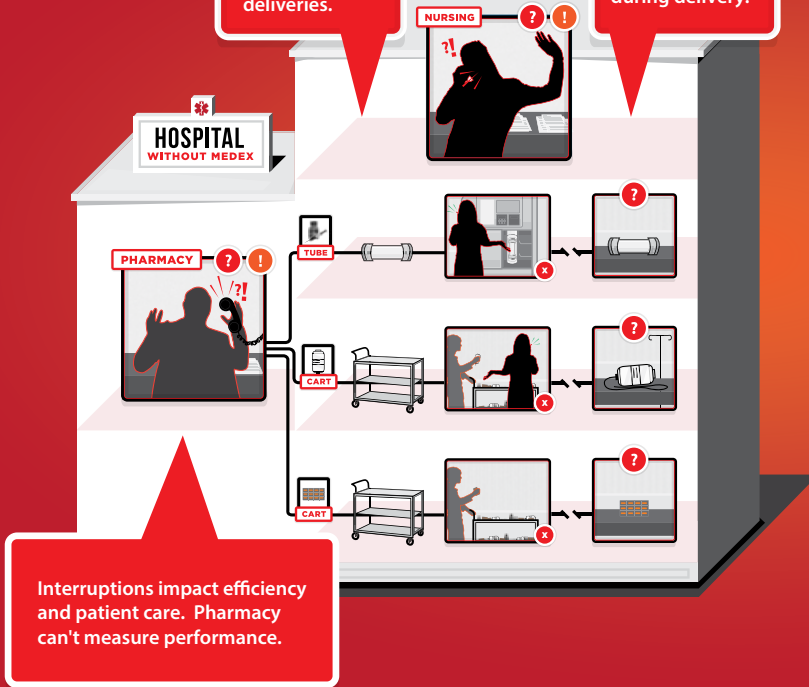

Missing or lost medication deliveries waste nursing and pharmacy time, reduce safety and impact patient satisfaction.

# MedEx™ is the Solution.

TRACK IT • MEASURE IT • PROVE IT

Join us in the San Pedro suite on Monday night for some fun!



[www.aethon.com/trackit](http://www.aethon.com/trackit)

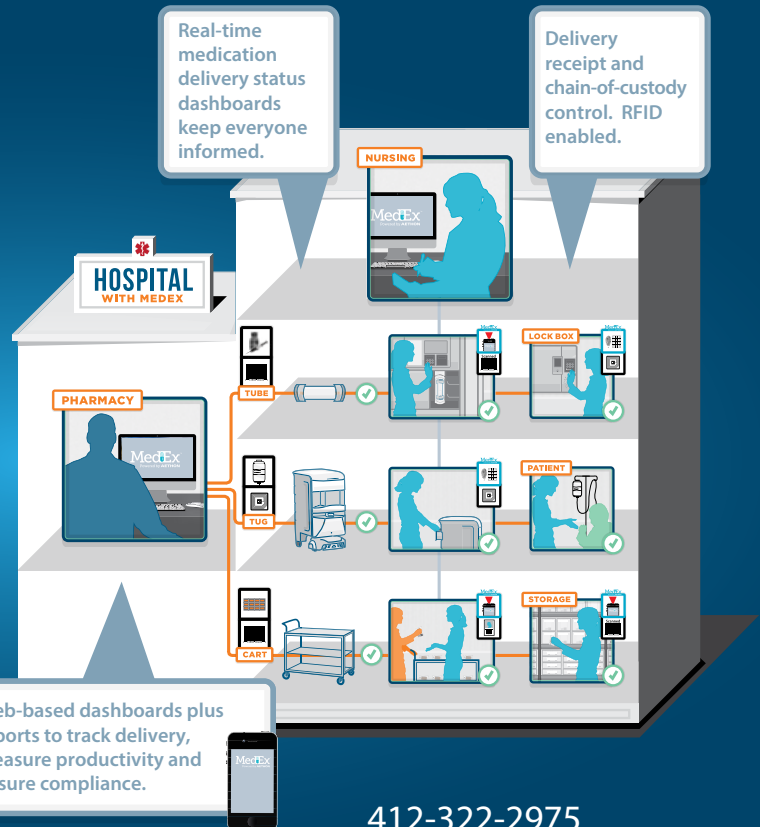

412-322-2975  
[inquiries@aethon.com](mailto:inquiries@aethon.com)

# The Go-To Product your Physicians Trust

## Now Available Jetco® 10-Pack Cannulas

### Cannula Features:

- Disposable or reprocessable
- Delivers precise, controlled spray
- Malleable cannula can be modified to accommodate special requirements



# Cetacaine®

## TOPICAL ANESTHETIC SPRAY

(Benzocaine 14.0%, Butamben 2.0%, Tetracaine Hydrochloride 2.0%)

### Ordering Info

10223-0201-01 Cetacaine Topical Anesthetic Spray, 56 g bottle & 1 Cannula  
 10223-0205-16 Cetacaine Jetco® J-4 Cannula 10-pack

### Amerisource Bergen

10039085  
 10010826

### Cardinal Health

1284363  
 3269925

### McKesson

1847508  
 2702314

**Please contact your preferred distributor if not listed above.**

Cetylite participates in the following GPO contracts: Premier, Novation, MedAssets, Amerinet and Health Trust Purchasing Group

cetacaine.com | 800-257-7740



# SUPPLIER SHOWCASE



## SAN DIEGO BALLROOM

MONDAY, OCTOBER 14 • 12:00 PM - 4:00 PM

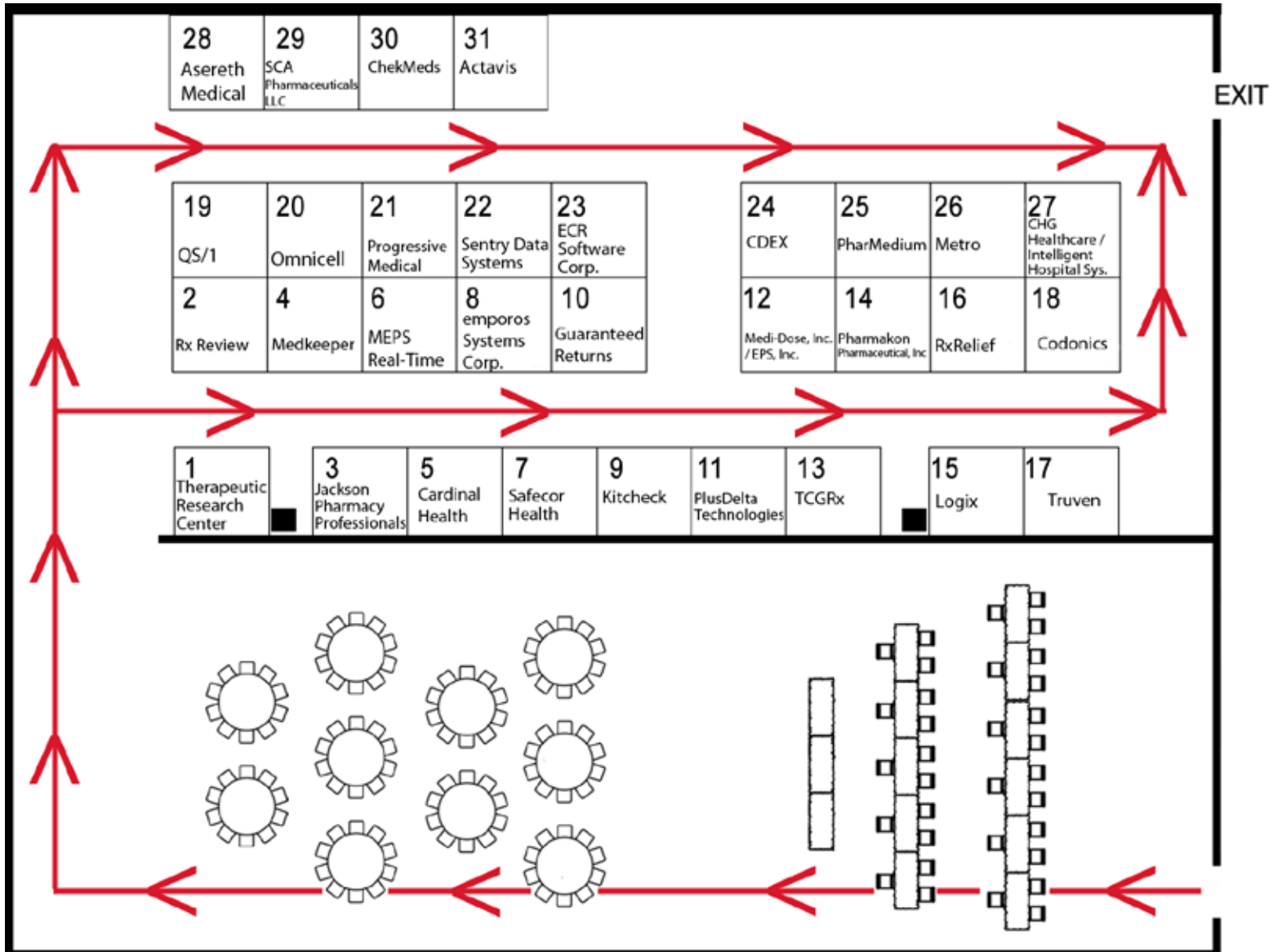

If you missed out on being part of the supplier showcase in Los Angeles, you have a chance to expand your presence at the 2014 Spring Hospital Pharmacy Conference in St. Louis. We have a limited number of 10'x10' showcases available from 12:00 pm - 4:00 pm on the first day of the conference to showcase your company.

**Providers that stop by 16 of the 31 Showcases will be entered to win an iPad!**

Contact Jason Green for more information about this exciting new opportunity: 843-689-9996.

# HOSPITALITY SUITES



DON'T MISS OUT ON THE **HOSPITALITY SUITES**



**Monday Night** following our Welcome Reception

**7:30 pm - . . .**

BE SURE TO VISIT OUR TITLE SPONSOR'S SUITE  
LOBBY LEVEL • BEAUDRY A



*And don't miss the party on the 31<sup>st</sup> floor  
with a view of the Hollywood sign!*



## PROVIDERS:

Don't forget your badge – you will need it to enter the hospitality suites. Start your evening in the suite that matches the logo on the back of your badge. If you are scanned into at least 15 hospitality suites, you will be entered in a drawing for a very special Nashville themed gift.

# HOSPITALITY SUITES



MONDAY, OCTOBER 14 • 7:30 PM - ...

<b>SPONSOR</b>	<b>LEVEL</b>	<b>ROOM</b>
Cardinal Health	Lobby Level	Beaudry A
Actavis	Lobby Level	La Brea
Aethon	Lobby Level	San Pedro
AMAG	31 <sup>st</sup> Floor	Room 3108
AmerisourceBergen	Lobby Level	San Gabriel C
Cadence Pharmaceuticals	Lobby Level	San Fernando
Cantrell Drug Company	Lobby Level	Santa Barbara B
CareFusion	Lobby Level	Beaudry B
CHG Healthcare	Level 3	Santa Monica B
CSL Behring	Lobby Level	Los Cerritos
Grifols	Lobby Level	Los Feliz
Johnson & Johnson	Lobby Level	Santa Anita A
McKesson	Lobby Level	San Gabriel A
Pacira	Lobby Level	Santa Barbara C
PDM Healthcare	Lobby Level	Santa Anita B
PharMEDium	Lobby Level	Santa Barbara A
Prodigy	Level 3	Santa Monica C
Salix Pharmaceuticals	Lobby Level	San Bernardino
Truven Health Analytics	Lobby Level	Palos Verdes
Unique Pharmaceuticals (UPI)	Lobby Level	Santa Anita C
Wolters Kluwer/Lexi Comp/PharmacyOne Source	Lobby Level	San Gabriel B

# DINNER & ENTERTAINMENT

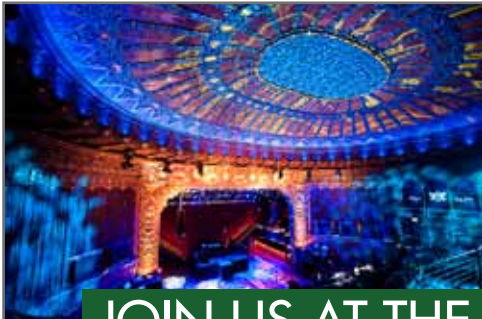

JOIN US AT THE **BELASCO THEATER**

Come prepared to eat & **drink the night away!**

On Tuesday night, join us for an unforgettable Los Angeles evening at the Belasco. Built in 1926, the theater opened with the stage version of *Gentlemen Prefer Blondes* – the first of many productions to grace the stage with stars like Humphrey Bogart and Helen Hayes. Over the decades, the theater served as a film set for everything from *The Prestige* to *Memoirs of a Geisha*. After a 20 year closure and a \$10 million dollar renovation, today the theater is a popular destination for celebrity photo shoots, filming, and private Hollywood events. Come prepared for the full red carpet treatment (including photo-ops with special guests), wonderful food and open bars.

After dinner, dust off your bellbottoms and get ready to boogie down to all your favorite hits from the 70s, including the Bee Gees, K.C. and the Sunshine Band, Donna Summer and many more. If you can still dig it, join us as we travel back in time with Grooveline for an hour of disco delight.

We'll close off the evening with the M-80s, a rockin' 80s new wave band covering everything from "Just Like Heaven" by the Cure to "The Safety Dance" by Men Without Hats. If you were a wild child of the 80s, don't forget your Members Only jackets and crimped hair. The M-80s won't!



Shuttles will run continuously between the Westin Bonaventure and The Belasco Theater from 5:45 pm - 10:00 pm.

SPONSORED BY



Premium Sponsor of each 2013 HCP Conference

**GRIFOLS**



**THANK YOU PDM HEALTHCARE**



SPECIAL THANKS TO PDM HEALTHCARE FOR THEIR  
PREMIUM SPONSORSHIP OF EACH 2013 HCP CONFERENCE



# EDUCATIONAL SESSIONS



**TUESDAY** OCTOBER 15

## OPENING REMARKS AND KEYNOTE ADDRESS

8:00 AM - 9:30 AM • California Ballroom  
ACPE # 0761-9999-13-364-L04-P 1.5 credit hours



### Keynote Speaker: Mark Scharenbroich, CSP, CPAE

**N**ice Bike – Making Connections That Move People. Mix thousands of black leather, bandana wearing Harley-Davidson riders, one 100th year anniversary celebration and a beige Ford Taurus and you get the Nice Bike principle in action. Join author and business speaker Mark Scharenbroich as he takes us on a ride to building stronger and more meaningful connections in our personal and professional lives. Mark will inspire you, motivate you, and validate the importance of recognizing people to improve employee and team performance. Whether you are a team of one, or a team of one hundred, you will walk away from this keynote with a reinvigorated



spirit for what you do, as well as an appreciation of what the other team members around you do.

Part motivational speaker, part thought-provoker, and pure entertainer, Mark tells engaging stories on how to develop meaningful connections. Mark's credentials include: Emmy award winner; author of *Nice Bike: Making Meaningful Connections on the Road of Life*; inducted into the National Speaker's Association Hall of Fame; International film awards for his film, *The Greatest Days of Your Life... (so far)*.

### **LEARNING OBJECTIVES:**

*The Nice Bike principle will demonstrate the three powerful steps to develop stronger relationships in our work which result in:*

- Improved employee engagement
- Enhanced team collaboration
- Embracing innovation vs. the fear of change
- Fueling the passion to serve others
- Creating meaningful connections

# EDUCATIONAL SESSIONS



## TUESDAY OCTOBER 15

### EDUCATIONAL SESSION: 2013 C-SUITE AGENDA

9:45 AM - 11:45 AM • California Ballroom  
ACPE # 0761-9999-13-365-L04-P 2 credit hours



#### Speaker: Brandi Greenberg

For the past nine years, Brandi has helped grow the Advisory Board Company's offerings for non-hospital organizations, working with a broad cross-section of medical technology, biopharmaceutical, information technology, architecture, and health care services firms to enhance their understanding of the dynamic U.S. health care delivery landscape. She has authored several reports on provider-supplier relations, the economic downturn, and health care reform. Brandi also spent two years as a Senior Consultant with the Advisory Board's syndicated research division. Her research focused broadly on hospital revenue enhancement strategies, with a special emphasis on marketing, hospital-physician relationships, and customer service operations. She co-authored a report entitled Service Innovations in Specialty Care and has interviewed over 500 hospital executives, line managers, and vendors. Prior to assuming her current role, Brandi was a Practice Manager with the Los Angeles office of the Boston Consulting Group. Brandi received her MBA from the Stanford Graduate School of Business, where she graduated as an Arjay Miller scholar. She also holds an MA in Rhetoric from Duke University and an AB with honors in English and American Studies from Stanford University.



#### **LEARNING OBJECTIVES:**

*Upon completion of this session, participants will be able to:*

- Describe the election's impact to the bottom line of hospitals and healthsystems
- Describe the clinical and operational metrics that matter most to Hospital Pharmacy executives
- List the emerging opportunities to partner with provider organizations to achieve accountable care goals

#### **PLEASE NOTE:**

BE SURE TO HAVE YOUR NAME BADGE WITH YOU AND SCANNED BEFORE EACH EDUCATIONAL SESSION.  
CE CREDIT WILL BE AWARDED BASED ON BADGE SCANS PER SESSION.



## TUESDAY OCTOBER 15

### EDUCATIONAL SESSION: PHARMACY PRACTICE MODEL INITIATIVE: TRANSFORMING PHARMACY PRACTICE

1:00 PM - 2:30 PM • California Ballroom  
ACPE # 0761-9999-13-366-L04-P 1.5 credit hours



#### Speaker: Steven Nelson

Steven P. Nelson is the Director, Center on Pharmacy Practice Advancement at the American Society of Health-System Pharmacists, Bethesda, Maryland. Mr. Nelson is responsible for coordinating programs related to the Pharmacy Practice Model Initiative. This initiative is a joint initiative of ASHP and the ASHP Research and Education foundation and is focused on transforming the practice of pharmacy to enhance the role of the pharmacist in providing direct patient care services. Prior to joining ASHP in October 2012, Mr. Nelson was in a variety of administrative positions in the Department of Pharmaceutical Care at the University of Iowa Hospitals and Clinics in Iowa City, Iowa for more than 25 years. Prior to Iowa, he also served as Chief of Pharmacy Services at the VA Medical and Regional Office in Fargo, ND for six years. Mr. Nelson received his Bachelor's degree in Pharmacy from North Dakota State University and his Master's degree in Hospital Pharmacy from North Dakota State University. He completed his residency at the Veterans Administration Medical Center in Fargo, North Dakota.



#### **LEARNING OBJECTIVES:**

*Upon completion of this session, participants will be able to:*

- Discuss trends from the PPMI Hospital Self-Assessment Tool
- Describe PPMI implementation activities, resources and strategies
- Describe the ways in which the pharmacy profession must change to advance its patient care contribution
- Identify opportunities for pharmacists to participate in pharmacy practice model change activities

*Educational Review Systems is accredited by the Accreditation Council for Pharmacy Education (ACPE) as a provider of continuing pharmaceutical education. This program is approved for up to 6 hours (0.6 CEUs) of continuing pharmacy education credit. Proof of participation will be posted to your NABP CPE profile within 4 to 6 weeks to participants who have successfully completed the post-test. Participants must participate in the entire presentation and complete the course evaluation to receive continuing pharmacy education credit. ACPE # 0761-9999-13-364-L04-P to 0761-9999-13-376-L04-P*



# EDUCATIONAL SESSIONS



## WEDNESDAY OCTOBER 16

### EDUCATIONAL SESSION: THE FUTURE OF THE HOSPITAL PHARMACY

10:30 AM - 11:30 AM • California Ballroom  
ACPE # 0761-9999-13-367-L04-P 1 credit hour



**Speakers: Amir Emamifar, PharmD, MBA**  
**Marcelle Levy-Santoro, MS, RPh, FNAPH**

**A**mir Emamifar, PharmD, MBA, is the Associate Administrator and Chief of Pharmacy Services at Emory Healthcare System in Atlanta, Georgia. He is also the Professor and Assistant Dean for Clinical Education at Emory for Mercer University College of Pharmacy. Dr. Emamifar received his undergraduate pharmacy degree from the University of Oklahoma College of Pharmacy and his doctorate of

pharmacy degree from University of Colorado College of Pharmacy. He also received a Master of Business Administration in Healthcare Administration from Our Lady of the Lake University of San Antonio with high honors. He is a Leonard Davis Institute of Health Economics of Wharton School of Business at University of Pennsylvania and Woodruff Leadership Academy Fellow of Emory University.



#### **LEARNING OBJECTIVES:**

- Identify the Pharmacy Manpower Project
- Understand and differentiate trends in pharmacy workforce
- Explain manpower supply and demand dynamics
- Become familiar with the trends in consumer driven health care relevant to pharmacy practice
- Familiarize the audience with medication use systems to reduce drug related mortality and morbidity, the concept of patients' ownership of personal data, and value based reimbursement practices
- Discuss future challenges and opportunities

**M**arcelle Levy-Santoro, MS, RPh, FNAPH, is the Pharmacy Administrator at Nassau University Medical Center, NuHealth System, and is an adjunct faculty for pharmacology at NYU. She is a consultant for pharmacy management with



a national company. Prior to joining NuHealth she was the director of Pharmacy at Bellevue Hospital Center and at Elmhurst Hospital Center. She received a master's degree in Pharmacy Administration and a bachelor's degree in Pharmaceutical Science from Saint John's University, as well as bachelors' degrees in Spanish Literature and French Literature from Queens College, NY. She is a Fellow of NAPH. She served as an advisory board member in Metro Plus, and SNPFA, and presently serves as an advisory board member in the GNHA and for Health Connect Partners.

# EDUCATIONAL ADVISORY BOARD



Over the past year, this committee volunteered their valuable time to help us create an outstanding agenda. We appreciate their energy and want to recognize this esteemed group for all their hard work. Without their expertise, this event would not have been possible.



**PHARMACY BOARD CHAIRMAN: Paul Troiano, RPh, MS, FACHE**  
Administrative Director of System Pharmacy, Trinity Mother Frances Hospital & Clinics

Paul has 25 years of experience in the institutional setting practice which includes large community hospitals and teaching and learning institutions. He is a Fellow in the American College of Healthcare Executives, certified as a green belt in the Lean methodology and is a past Keystone Alliance for Performance Excellence (KAPE) examiner. He maintains active involvement in several professional organizations including ASHP and ACHE.

**VICE CHAIR:**

**BRIAN ROMIG, BS, RPh, MBA**

VP, Clinical & Support Services, Cone Health

**MARY HELEN BOWEN**

Assistant VP, Pharmacy Services, St. Dominic Hospital

**ARASH DABESTANI, PharmD, MHA, FASHP, FABC**

Senior Director of Pharmacy, NYU Langone Medical Center

**JAMES DEFAZIO**

Director Clinical Value Analysis & Pharmacy, Bon Secours Health System, Inc.

**JAMES ELDRIDGE, PharmD, MBA**

Director, Pharmacy Utilization and Operations, HealthTrust - HCA

**AMIR EMAMIFAR, PharmD, MBA**

Associate Administrator, Pharmaceutical Services, Emory Healthcare

**JOHN KLEISS, PharmD**

Executive Director, Mercy (ROi)

**MARCELLE LEVY-SANTORO, MS, RPh, FNAPH**

Administrator of Pharmacy Services, Nassau University Medical Center

**RICHARD MENDRIBIL, PharmD**

Health System Director of Pharmacy Services, Northern Arizona Health

**MARSHALL ROBBINS, PharmD**

Director of Pharmacy, Crestwood Medical Center

**MICHAEL SIEVERS, RPh**

Network Director, Pharmacy Services, Lutheran Hospital of Indiana



## THE UNIQUE REVERSE EXPO



In the Reverse EXPO sessions, Pharmacy Directors and GPO Executives host exhibit tables while suppliers walk through the hall. This unique event is a fun change of pace from traditional expo formats and provides the best networking opportunity for both providers and suppliers.

On the next page, you will find a map outlining the location of each booth in the hall. Please refer to the list of specific booth assignments (pages 24 - 38) to locate each provider executive during the Reverse EXPO.

### PASADENA ROOM

Session 1: Tuesday, October 15, 3:00 PM - 5:00 PM

Session 2: Wednesday, October 16, 8:00 AM - 10:00 AM

SPONSORED BY



# CareFusion



# EXHIBIT HALL

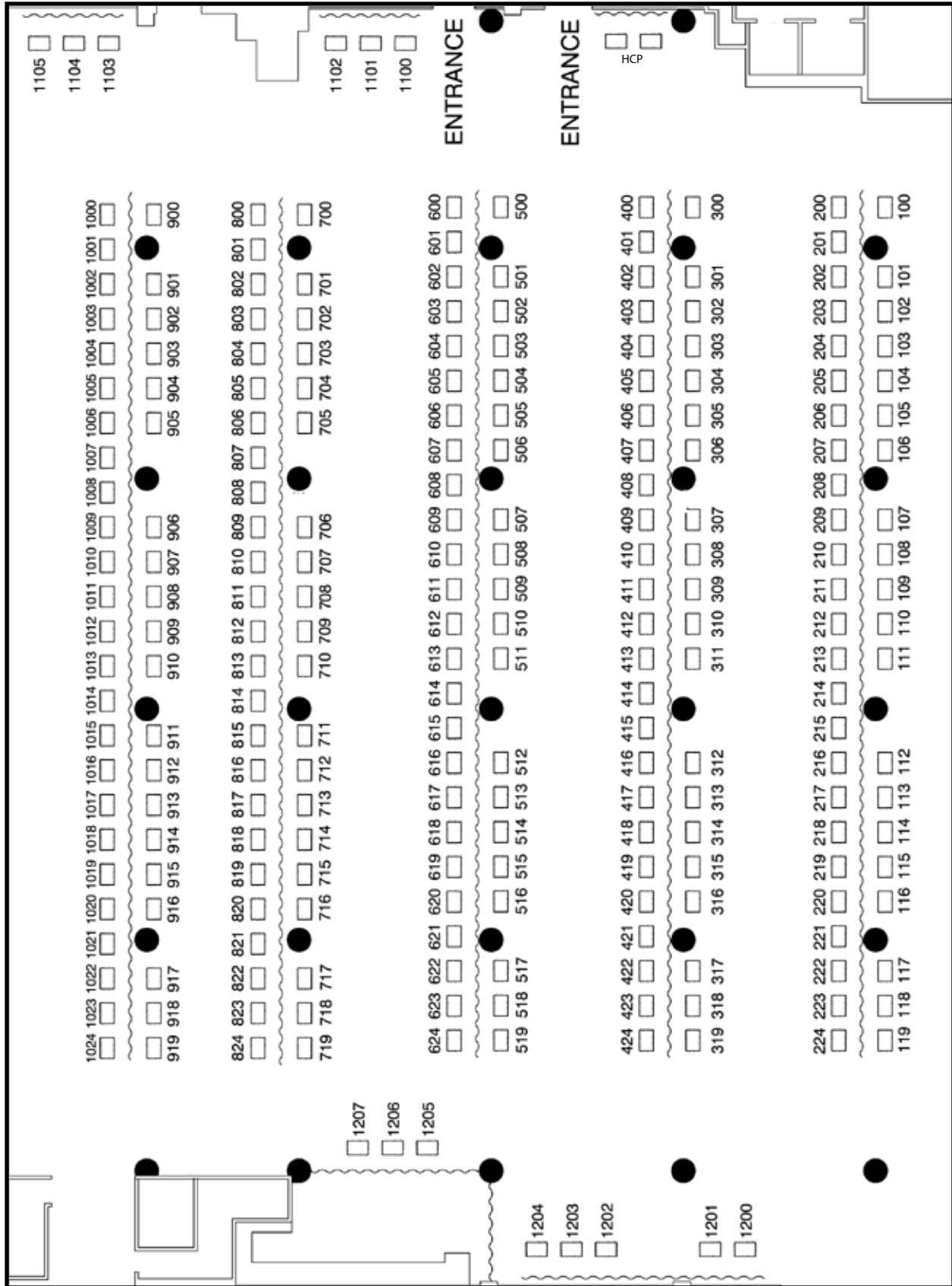

# YOUR TRUSTED SOURCE

"We've got your back!"

Visit our hospitality suite  
in Santa Barbara B on  
Monday evening



Lance Lanier, BS Pharmacy  
Business Development

Tracye Easterly  
Regulatory Coordinator

Mike Pierce  
President

Dell McCarley, PD  
Chairman/CEO

Kim McDonough, Pharm D  
Compounding Pharmacist

Chris Hutts, Pharm D  
Pharmacist in Charge



## CANTRELL DRUG COMPANY

*Pharmaceutical Outsourcing Specialists*

### **FDA Registered Supplier of Outsourced Pharmacy Preparations.**

Our experience with cGMP focused policies and procedures along with carefully designed facilities, equipment, training and testing, provide confidence to our customers in the quality of our services.

**QUALITY › SERVICE › EXPERIENCE**

**877-666-5222**

[www.cantrelldrug.com](http://www.cantrelldrug.com)

# PROVIDER ATTENDEES LIST BY FACILITY



## **Adventist Health System**

### **Booth #1204**

Sanford, FL  
Trenia Yielding, PharmD  
Director of Pharmacy  
Bedsizes: 7700  
Outpatient Pharmacy: Yes

## **Adventist LaGrange Memorial Hospital**

### **Booth #1202**

LaGrange, IL  
David Tsang  
Director of Pharmacy  
Bedsizes: 200

## **Alamance Regional Medical Center**

### **Booth #803**

Burlington, NC  
Sandra Faucette, PharmD  
Director of Pharmacy  
Bedsizes: 238

## **Alameda Health System**

### **Booth #105**

San Leandro, CA  
Sheila Ingram, PharmD  
Area Director of Pharmacy Services  
Bedsizes: 350

## **Alameda Hospital**

### **Booth #106**

Alameda, CA  
Ari Arshi, PharmD  
DOP  
Bedsizes: 153

## **Amerinet, Inc.**

### **Booth #103**

St. Louis, MO  
Valerie Peters Bandy, PharmD, MBA, BS, RPh  
Senior Director, Pharmacy Specialists

## **Amerinet, Inc.**

### **Booth #104**

St. Louis, MO  
Stacey Winston  
Sr. Director, Contracting Solutions

## **Amerinet/Health Resource Services, LLC**

### **Booth #102**

Seattle, WA  
David Lynn Hardy, MS, RPh  
Vice President, Pharmacy Services

## **Anaheim Regional Medical Center**

### **Booth #117**

Anaheim, CA  
Martin Torres, PharmD  
Director of Pharmacy  
Bedsizes: 223

## **Arnold Palmer Medical Ctr (Orlando Hlth)**

### **Booth #1205**

Orlando, FL  
Meena Morgan, PharmD, CPh  
Administrator, Ancillary Services  
Bedsizes: 1800  
Outpatient Pharmacy: Yes

## **Aultman Hospital**

### **Booth #509**

Canton, OH  
James Toohey, MS, RPh  
Director of Pharmacy  
Bedsizes: 682  
Outpatient Pharmacy: Yes

## **Avera St. Luke's Hospital**

### **Booth #517**

Aberdeen, SD  
Alvin Haugen, PharmD  
Pharmacy Director  
Bedsizes: 133

## **Baxter Regional Medical Center**

### **Booth #822**

Mountain Home, AR  
Angela Powell, PharmD  
Director of Pharmacy  
Bedsizes: 268  
Outpatient Pharmacy: Yes

## **BJC Healthcare**

### **Booth #406**

St. Louis, MO  
SueEllen Turner  
Corporate Pharmacy Contract Manager  
Bedsizes: 3600  
Outpatient Pharmacy: Yes

## **Bon Secours Health System, Inc.**

### **Booth #710**

Columbia, MD  
James DeFazio  
Director Clinical Value Analysis & Pharmacy  
Bedsizes: 3836  
Outpatient Pharmacy: Yes

## **Bristol Regional Medical Center**

### **Booth #816**

Bristol, TN  
Dwight Owens, PharmD  
Director of Pharmacy  
Bedsizes: 384

## **Cancer Treatment Centers of America**

### **Booth #421**

Zion, IL  
Joseph Coyne, RPh  
Vice President of Pharmacy Services  
Bedsizes: 54  
Outpatient Pharmacy: Yes

## **Capital Health Regional Medical Center**

### **Booth #620**

Trenton, NJ  
Chester Lau  
Director of Pharmacy  
Bedsizes: 289

## **Carilion Clinic**

### **Booth #708**

Roanoke, VA  
Clara Anne Spencer, RPh  
Director of Pharmacy Contracting  
Bedsizes: 1185  
Outpatient Pharmacy: Yes

## **Carilion Roanoke Memorial Hospital**

### **Booth #707**

Roanoke, VA  
Ronald Lee Spellman, RPh  
Director, Pharmacy Compliance & Med Safety  
Bedsizes: 763  
Outpatient Pharmacy: Yes

## **Carroll Hospital Center**

### **Booth #711**

Westminster, MD  
Larry Siegel, PharmD  
Director of Pharmacy  
Bedsizes: 200

## **Castle Medical Center**

### **Booth #309**

Kailua, HI  
Maria Holmes, RPh  
Director of Pharmacy  
Bedsizes: 160

## **Children's Hospital Central California**

### **Booth #108**

Madera, CA  
Richard Sakai, PharmD, FASHP, FCSHP  
Director of Pharmacy  
Bedsizes: 358

**Nymalize**<sup>®</sup>  
(nimodipine) oral solution  
60 mg/20 mL

**CUPS NOW  
AVAILABLE**

# NOW AVAILABLE

The first and only FDA-approved  
nimodipine oral solution in:

- 60 mg (20mL) cups
- 16-ounce (473 mL) bottles

For Important Safety Information and  
full Prescribing Information, please visit  
[Nymalize.com](http://Nymalize.com)



# PROVIDER ATTENDEES LIST BY FACILITY



## **Christian Hospital (BJC)**

### **Booth #405**

St. Louis, MO  
Nancy Konieczny  
Director of Pharmacy & Pulmonary Services  
*Bedsizes: 485*  
*Outpatient Pharmacy: Yes*

## **Christus Health**

### **Booth #918**

Lake Charles, LA  
Myra Thomas, RPh  
Director, Resource Utilization Pharmacy  
*Bedsizes: 200*

## **CHRISTUS Health Spohn Memorial Hospital**

### **Booth #916**

Corpus Christi, TX  
Christopher W. Miller, PharmD, BCPP  
Director of Pharmacy Services  
*Bedsizes: 1049*  
*Outpatient Pharmacy: Yes*

## **CHRISTUS Hospital - St. Mary**

### **Booth #915**

Port Arthur, TX  
John Gonzalez  
Pharmacy Director  
*Bedsizes: 227*

## **CHRISTUS Hospital - St. Elizabeth**

### **Booth #914**

Beaumont, TX  
Thomas Welch, RPh  
Pharmacy Director  
*Bedsizes: 461*

## **CHRISTUS Spohn Hospital Corpus Christi-S.**

### **Booth #913**

Corpus Christi, TX  
Elias Cavazos, RPh  
Director of Pharmacy  
*Bedsizes: 154*

## **CHRISTUS St. John Hospital**

### **Booth #912**

Nassau Bay, TX  
Thao Tran, RPh  
Director of Pharmacy  
*Bedsizes: 170*

## **CHRISTUS St. Michael Health System**

### **Booth #911**

Texarkana, TX  
Dale Smith, RPh  
Director of Pharmacy  
*Bedsizes: 320*  
*Outpatient Pharmacy: Yes*

## **CHRISTUS St. Patrick Hospital**

### **Booth #917**

Lake Charles, LA  
Shanna Thibodeaux  
Director of Pharmacy  
*Bedsizes: 392*

## **Coastal Carolinas Health Alliance**

### **Booth #804**

Wilmington, NC  
Derrick Billups, MSM, FACHE  
Director of Operations & Corporate Contracts  
*Bedsizes: 3700*  
*Outpatient Pharmacy: Yes*

## **Coler-Goldwater Specialty Hospital**

### **Booth #601**

New York, NY  
Richard Wenzel  
Director of Pharmacy  
*Bedsizes: 1025*

## **Columbus Regional Hospital**

### **Booth #518**

Columbus, IN  
Ben Caughey  
Director of Pharmacy  
*Bedsizes: 325*  
*Outpatient Pharmacy: Yes*

## **Community Hospital of Huntington Park**

### **Booth #109**

Huntington Park, CA  
Rick Yoshida, PharmD  
DOP  
*Bedsizes: 190*

## **Community Memorial Hospital**

### **Booth #110**

Ventura, CA  
Gene Day  
Director of Pharmacy  
*Bedsizes: 240*

## **Cone Health**

### **Booth #805**

Greensboro, NC  
Brian Romig, BS, RPh, MBA  
VP, Clinical & Support Services  
*Bedsizes: 1122*  
*Outpatient Pharmacy: Yes*

## **Conemaugh Health System**

### **Booth #507**

Johnstown, PA  
Terri Gritzer  
Director of Pharmacy  
*Bedsizes: 500*

## **Coney Island Hospital**

### **Booth #602**

Brooklyn, NY  
Warren Lakoff, RPh, MS  
Director of Pharmacy  
*Bedsizes: 379*  
*Outpatient Pharmacy: Yes*

## **Corona Regional Medical Center**

### **Booth #111**

Corona, CA  
Alise Elayne Hadley  
DOP  
*Bedsizes: 228*  
*Outpatient Pharmacy: Yes*

## **Cottage Health System**

### **Booth #112**

Santa Barbara, CA  
Allan Cohen, PharmD, MBA  
Director of Pharmacy Services  
*Bedsizes: 525*

## **Covenant Medical Center**

### **Booth #412**

Waterloo, IA  
John Hamiel, PharmD  
Director of Pharmacy  
*Bedsizes: 423*  
*Outpatient Pharmacy: Yes*

## **Covenant Medical Inc. Harrison**

### **Booth #516**

Saginaw, MI  
Terry Wernette, RPh  
Director of Pharmacy  
*Bedsizes: 623*  
*Outpatient Pharmacy: Yes*

## **Crestwood Medical Center**

### **Booth #1009**

Huntsville, AL  
Marshall E. Robbins, PharmD  
Director of Pharmacy  
*Bedsizes: 150*

## **Crouse Hospital**

### **Booth #600**

Syracuse, NY  
Barbara L. McNiff, PharmD  
Director of Pharmacy  
*Bedsizes: 506*

## **Denton Regional Medical Center**

### **Booth #824**

Denton, TX  
John D. Kanell, PharmD, BCPS  
Assistant Director of Pharmacy  
*Bedsizes: 220*



# Wondering if that "next-generation" medication management technology will live up to promises?



Why wait to find out? Join the nearly 1,000 healthcare facilities that have already put next-generation technology to work with the proven Omnicell® G4 Unity medication management platform.

**You won't be alone:** four out of five business days a new healthcare facility installs an Omnicell system.



With the demands of cost-driven reform impacting your enterprise, don't you owe it to your organization to evaluate your options? Before investing in your next system upgrade, investigate the award-winning Omnicell automation solutions your fellow clinical leaders rated as best in the class.

**2013 KLAS #1 Overall Pharmacy Automation Equipment Vendor**  
**2010-2013 Best in KLAS — Omnicell OmniRx®**

Best in KLAS Awards Medical Equipment & Infrastructure Report June 2013 ©2013 KLAS Enterprises, LLC. All rights reserved. [www.KLASresearch.com](http://www.KLASresearch.com)

Call 855-306-7926 or visit [www.Omnicell.com](http://www.Omnicell.com) to learn more.



# PROVIDER ATTENDEES LIST BY FACILITY



## **Desert Springs Hospital**

### **Booth #317**

Las Vegas, NV  
Evelyn Chu, PharmD, BCPS  
Director of Pharmacy  
Bedsizes: 240

## **Downey Regional Medical Center**

### **Booth #113**

Downey, CA  
Daphnie Nguyen  
DOP  
Bedsizes: 199

## **Einstein Healthcare Network**

### **Booth #504**

Philadelphia, PA  
Deborah Hauser, RPh, MHA  
Network Director of Pharmacy  
Bedsizes: 1184  
Outpatient Pharmacy: Yes

## **Emory Healthcare**

### **Booth #1014**

Atlanta, GA  
Amir Emamifar, PharmD, MBA  
Associate Administrator, Pharmaceutical Svcs  
Bedsizes: 1800  
Outpatient Pharmacy: Yes

## **Englewood Hospital and Medical Center**

### **Booth #621**

Englewood, NJ  
Jeffrey Nemeth, BSpH, PharmD, MPA  
Director of Pharmacy  
Bedsizes: 520

## **Ephraim McDowell Regional Medical Ctr**

### **Booth #800**

Danville, KY  
Joan B. Haltom, PharmD  
Director of Pharmacy  
Bedsizes: 225

## **Fairview Hospital**

### **Booth #508**

Cleveland, OH  
Michael Hoying, RPh, MS  
Director of Pharmacy  
Bedsizes: 468  
Outpatient Pharmacy: Yes

## **Florida Hospital North Pinellas**

### **Booth #1203**

Tarpon Springs, FL  
James Lombard, MSc  
Director of Pharmacy  
Bedsizes: 168

## **Fountain Valley Regional Hosp & Med Ctr**

### **Booth #114**

Fountain Valley, CA  
Ted Kim, PharmD  
DOP  
Bedsizes: 400  
Outpatient Pharmacy: Yes

## **Froedtert & The Medical College of WI**

### **Booth #418**

Milwaukee, WI  
Katie McMillen, PharmD, MPH, MHA  
Assistant Director of Pharmacy  
Bedsizes: 500  
Outpatient Pharmacy: Yes

## **Froedtert & The Medical College of WI**

### **Booth #417**

Milwaukee, WI  
Chris Sanders, PharmD  
Operations Manager  
Bedsizes: 500

## **Garden City Hospital**

### **Booth #515**

Garden City, MI  
Carol Welch, PharmD, MS  
Director of Pharmacy  
Bedsizes: 220  
Outpatient Pharmacy: Yes

## **Garfield Medical Center**

### **Booth #118**

Monterey Park, CA  
Edwin Chan  
DOP  
Bedsizes: 210

## **Geisinger Health System**

### **Booth #506**

Danville, PA  
John Ralph Jones, RPh  
Vice President  
Bedsizes: 937  
Outpatient Pharmacy: Yes

## **Geisinger Medical Center**

### **Booth #505**

Danville, PA  
David Klinger, RPh  
Director of Pharmacy  
Bedsizes: 500

## **George Washington University Hospital**

### **Booth #712**

Washington, DC  
Renia Mathews, PharmD  
Director of Pharmacy  
Bedsizes: 370

## **Glendale Adventist Medical Center**

### **Booth #308**

Glendale, CA  
Romic M. Eskandarian, PharmD  
Director of Pharmacy  
Bedsizes: 550

## **Good Samaritan Hospital**

### **Booth #115**

Los Angeles, CA  
Mark Holdych  
Director of Pharmacy  
Bedsizes: 408

## **Good Samaritan Hospital**

### **Booth #116**

San Jose, CA  
Trang Le  
Director of Pharmacy  
Bedsizes: 474

## **Good Samaritan Hospital (CHI)**

### **Booth #402**

Kearney, NE  
Nicki Bohl, PharmD  
Director of Pharmacy  
Bedsizes: 286

## **Gouverneur Healthcare Services**

### **Booth #603**

New York, NY  
Althea Buckner, PharmD  
Director of Pharmacy  
Bedsizes: 210  
Outpatient Pharmacy: Yes

## **Gundersen Lutheran Health System**

### **Booth #416**

La Crosse, WI  
Jolene Garrett, PharmD, BCPS  
Assistant Pharmacy Director  
Bedsizes: 325

## **Hartford Hospital**

### **Booth #618**

Hartford, CT  
Michael Rubino, MS, RPh, FASHP  
Director of Pharmacy  
Bedsizes: 819



# PROVIDER ATTENDEES LIST BY FACILITY



## **HCA CJWMC Chippenham Hospital**

### **Booth #706**

Richmond, VA  
Robin M. Sayles, PharmD  
Assistant Director of Pharmacy Services  
*Bedsizes: 500*

## **HCA Healthcare**

### **Booth #814**

Nashville, TN  
Nicole Bryan, PharmD, MBA  
Dir., Performance Improvement-Pharmacy  
*Bedsizes: 18000*

## **HCA Henrico Doctors Hospital**

### **Booth #705**

Richmond, VA  
Courtney Fuller  
DOP  
*Bedsizes: 355*

## **Health First**

### **Booth #1020**

Melbourne, FL  
Michael Edwards, PharmD  
Division Director of Pharmacy  
*Bedsizes: 925*

## **Health First Hospitals**

### **Booth #1021**

Melbourne, FL  
Stephen Gilbert, PharmD, BCPS  
Clinical Pharmacy Manager  
*Bedsizes: 514*

## **HealthAlliance of Hudson Valley**

### **Booth #605**

Kingston, NY  
Priti Shah, RPh  
Director of Pharmacy Services  
*Bedsizes: 315*

## **Health-First**

### **Booth #1022**

Cocoa Beach, FL  
Jay Pauly, PharmD  
Clinical Coordinator, Pharmacy Services  
*Bedsizes: 1000*

## **HealthSouth Corporation**

### **Booth #622**

Toms River, NJ  
Brian Furbush, RPh  
Co-Chair, Pharmacy Leadership Board  
*Bedsizes: 9999*

## **HealthTrust-HCA**

### **Booth #815**

Brentwood, TN  
James Eldridge, PharmD, MBA  
Director, Pharmacy Utilization and Operations  
*Bedsizes: 1647*

## **Hemet Valley Medical Center**

### **Booth #220**

Hemet, CA  
Steve Kelso  
Pharmacy Director  
*Bedsizes: 460*

## **Highline Medical Center**

### **Booth #100**

Burien, WA  
Thuy Vo, PharmD  
Director of Pharmacy Services  
*Bedsizes: 269*

## **Hollywood Comm. Hosp.-Brotman Med Ctr.**

### **Booth #219**

Culver City, CA  
Kevin Kaneko, PharmD  
Director of Pharmacy  
*Bedsizes: 420*

## **Holston Valley Medical Center**

### **Booth #817**

Kingsport, TN  
Bill Carson, PharmD  
Director, Pharmacy Services  
*Bedsizes: 519*

## **Houston Methodist San Jacinto**

### **Booth #919**

Baytown, TX  
Edward Borner  
Director of Pharmacy  
*Bedsizes: 318*

## **Hunterdon Medical Center**

### **Booth #623**

Flemington, NJ  
David N. Adelman  
Director of Pharmacy Services  
*Bedsizes: 178*

## **Innovative Purchasing Concepts (St Barnabas)**

### **Booth #624**

West Orange, NJ  
Robert Pellechio, RPh  
Vice President

## **Jackson Purchase Medical Center (LifePoint)**

### **Booth #801**

Mayfield, KY  
Cynthia Elliott, RPh, CDE  
Director of Pharmacy  
*Bedsizes: 110*

## **Jeanes Hospital**

### **Booth #503**

Philadelphia, PA  
Donald R. Jones, MS, RPh  
Director of Pharmacy and Medication Safety  
*Bedsizes: 590*

## **Jewish Home Lifecare**

### **Booth #606**

New York, NY  
Renee Hofman  
Vice President, Pharmacy Services  
*Bedsizes: 1600*

## **Jordan Hospital**

### **Booth #614**

Plymouth, MA  
Kristina L. McGill  
Director of Pharmacy  
*Bedsizes: 155*

## **Kern Medical Center**

### **Booth #218**

Bakersfield, CA  
Aniece Amos  
Pharmacy Director  
*Bedsizes: 222*  
*Outpatient Pharmacy: Yes*

## **Kindred Healthcare Support Center**

### **Booth #802**

Louisville, KY  
James Poullard, PharmD, MBA  
Vice President of Pharmacy, Hospital Division  
*Bedsizes: 5000*

## **Kingman Regional Medical Center**

### **Booth #312**

Kingman, AZ  
William Bruce Latimer, BS Pharm, MBA  
Director, Pharmacy Services  
*Bedsizes: 237*

## **Lakewood Regional Medical Center**

### **Booth #217**

Lakewood, CA  
Smita Njeru  
Director of Pharmacy  
*Bedsizes: 169*

# PROVIDER ATTENDEES LIST BY FACILITY



## **Lawrence & Memorial Hospital Booth #619**

New London, CT  
Warren Rogers, RPh  
Director of Pharmacy Services  
*Bedsizes: 280*

## **Lehigh Valley Hospital–Muhlenberg Booth #502**

Bethlehem, PA  
Rhonda Thomas, PharmD, MBA  
Director of Pharmacy  
*Bedsizes: 250*

## **Lewistown Hospital Booth #501**

Lewistown, PA  
Richard Floyd Stomackin, BS Pharm  
Director of Pharmacy  
*Bedsizes: 123*  
*Outpatient Pharmacy: Yes*

## **Lexington Medical Center (WFBH) Booth #806**

Lexington, NC  
Joe Maki  
Director of Pharmacy  
*Bedsizes: 885*

## **Little Company of Mary Hosp. Torrance Lab Booth #216**

Torrance, CA  
Muno Bholat  
Director of Pharmacy  
*Bedsizes: 442*

## **Los Angeles Community Hospital Booth #214**

Los Angeles, CA  
Christine Joh  
Director of Pharmacy  
*Bedsizes: 180*

## **Lourdes Health System Booth #718**

Camden, NJ  
William Haigh  
Assistant Director  
*Bedsizes: 380*

## **Lutheran Hospital of Indiana Booth #519**

Fort Wayne, IN  
Michael Sievers, RPh  
Network Director, Pharmacy Services  
*Bedsizes: 972*

## **Madison Memorial Hospital Booth #310**

Rexburg, ID  
Dorsie Sullenger, RPh  
Director of Pharmacy & Respiratory Therapy  
*Bedsizes: 70*

## **Maricopa Integrated Health System Booth #313**

Phoenix, AZ  
Joyce Kossick  
Director of Pharmacy  
*Bedsizes: 450*

## **Martin Memorial Health Systems Booth #1206**

Stuart, FL  
David Harlow  
Chief Pharmacy Officer  
*Bedsizes: 450*

## **Mary Lanning Healthcare Booth #401**

Hastings, NE  
Roger L. Glen, PharmD  
Director of Pharmacy  
*Bedsizes: 180*

## **Maury Regional Medical Center Booth #818**

Columbia, TN  
Jefferson Binkley, PharmD, BCNSP, FASHP  
Director of Pharmacy  
*Bedsizes: 258*  
*Outpatient Pharmacy: Yes*

## **McLaren - Greater Lansing Booth #514**

Lansing, MI  
Ronald L. Cosson, MHA, RPh  
Administrative Director, Clinical Support  
*Bedsizes: 389*  
*Outpatient Pharmacy: Yes*

## **McLeod Health Booth #812**

Florence, SC  
Charles Rozak, MS  
Pharmacy Director  
*Bedsizes: 460*  
*Outpatient Pharmacy: Yes*

## **McLeod Regional Medical Center Booth #813**

Florence, SC  
Artie McKnight, RPh  
Pharmacy Business Manager  
*Bedsizes: 505*

## **MedAssets Booth #910**

Leander, TX  
Sam A. Colletti, RPh  
Director, Clinical Pharmacy - CHRISTUS Health

## **MedAssets Booth #909**

Plano, TX  
Martin McBride  
Pharmacy Lead Negotiator

## **MedAssets Advisory Solutions Booth #907**

Alpharetta, GA  
Greg Weeks, PharmD, MBA  
VP, Clinical Resource Management

## **MedAssets HSCA Booth #908**

Plano, TX  
Jimmy Loftin  
Vice President, Pharmacy Contracting

## **Medical Center Arlington Booth #906**

Arlington, TX  
Darrell Newcomer, MS, FASHP  
Director of Pharmacy  
*Bedsizes: 336*

## **Medical Center of Lewisville Booth #905**

Lewisville, TX  
Marilyn Jackson, PharmD, MBA  
Assistant Vice President, Pharmacy  
*Bedsizes: 206*

## **Medical Center of McKinney Booth #904**

McKinney, TX  
Fung Chang  
Pharmacy Director  
*Bedsizes: 260*

## **Mercy (ROi) Booth #409**

St. Louis, MO  
John R. Kleiss, PharmD  
Executive Director  
*Bedsizes: 4438*

## **Mercy El Reno, Watonga & Kingfisher Hosp. Booth #411**

Kingfisher, OK  
Marette Forman, DPh  
Mercy Rural Pharmacy Services Manager  
*Bedsizes: 75*





SET YOUR STANDARDS  
**HIGHER**

**Complete Medication Solutions for Hospitals**

- Highest-Rated Drug Reference
- Integrated Drug Decision Support
- Formulary Management & Communication
- Cost Monitoring & Control
- Medication Therapy Management
- Medication Alternatives
- The Highest Quality at The Best Price

visit us online at **goldstandard.com**

# PROVIDER ATTENDEES LIST BY FACILITY



## **Mercy Hospital Oklahoma City Booth #410**

Oklahoma City, OK  
Keith Madison, PharmD  
Regional Director of Pharmacy  
Bedsizes: 400  
Outpatient Pharmacy: Yes

## **Mercy Hospital Springfield Booth #408**

Springfield, MO  
Shane Edmonson  
Director of Acute Care Pharmacy  
Bedsizes: 886

## **Mercy Medical Center of Redding Booth #222**

Redding, CA  
John Choi  
Director of Pharmacy  
Bedsizes: 273

## **Mercy Philadelphia Hospital Booth #500**

Philadelphia, PA  
Yeo Joo Cho, RPh  
Director of Pharmacy  
Bedsizes: 178

## **Methodist Dallas Medical Center Booth #903**

Dallas, TX  
Jon Albrecht, RPh, MHA, BCNSP, FASHP  
Director of Pharmacy  
Bedsizes: 515

## **Methodist Dallas Medical Center Booth #902**

Dallas, TX  
Ilka Ratsaphangthong, PharmD, MHA, BCPS  
Clinical Pharmacy Manager  
Bedsizes: 515  
Outpatient Pharmacy: Yes

## **Methodist Women's Hospital Booth #400**

Omaha, NE  
Michele Higgins, PharmD  
Director of Pharmacy  
Bedsizes: 121

## **Metro Health Hospital Booth #513**

Wyoming, MI  
Peter Haverkamp, RPh  
Director of Pharmacy Services  
Bedsizes: 208

## **Mid America Service Solutions, LLC (VHA) Booth #1002**

Omaha, NE  
Ryan Flugge, PharmD BCPS  
Pharmacy Implementation Manager  
Bedsizes: 4126

## **Mid-America Division HCA, Parallon Booth #403**

Shawnee, KS  
Joseph W. Burwinkle, BS, MS  
Division Director of Pharmacy Operations  
Bedsizes: 1398

## **Ministry Health Care/St. Michaels Hospital Booth #415**

Stevens Point, WI  
Dave Groen  
Pharmacy Director  
Bedsizes: 120

## **Mission Health System Booth #807**

Asheville, NC  
John Randall, RPh, MBA  
Director of Pharmacy Supply Chain  
Bedsizes: 800

## **Mission Hospital Regional Medical Center Booth #213**

Mission Viejo, CA  
Tommy Mai  
Director of Pharmacy  
Bedsizes: 552  
Outpatient Pharmacy: Yes

## **Mobile Infirmary Booth #1011**

Mobile, AL  
Jennifer Broome, PharmD  
Medication Safety Pharmacist  
Bedsizes: 704  
Outpatient Pharmacy: Yes

## **Montclair Hospital Medical Center Booth #212**

Montclair, CA  
Edgar Arevalo  
DOP  
Bedsizes: 102

## **Mount Sinai Queens Booth #607**

Astoria, NY  
Philip Manning  
Director of Pharmacy  
Bedsizes: 250

## **Mountain States Health Alliance Booth #819**

Johnson City, TN  
Patricia Boone Tanner, DPh, CPh, MBA  
Corporate Director, Pharmacy Services  
Bedsizes: 1700  
Outpatient Pharmacy: Yes

## **Mt. Auburn Hospital Booth #615**

Cambridge, MA  
Greg Sophis, MBA, RPh  
Director of Pharmacy Services  
Bedsizes: 217

## **Nassau University Medical Center Booth #608**

East Meadow, NY  
Marcelle Levy-Santoro, MS, RPh, FNAPH  
Administrator of Pharmacy Services  
Bedsizes: 450

## **National Park Medical Center Booth #823**

Hot Springs, AR  
Bill J. Reeves, PD, RPh, MBA  
Dir. of Pharmacy/Respiratory/Cardio-Neuro  
Bedsizes: 166

## **New Hanover Regional Medical Center Booth #808**

Wilmington, NC  
Mark E. Allen, RPh, MBA  
System Director of Pharmacy  
Bedsizes: 850  
Outpatient Pharmacy: Yes

## **New York City Health and Hospital Corp. Booth #604**

New York, NY  
Vincent Giambanco, RPh, MS  
Director of Procurement and Operations  
Bedsizes: 8338  
Outpatient Pharmacy: Yes

## **Norman Regional Health System Booth #1100**

Norman, OK  
Patricia Andrews  
Pharmacy Manager  
Bedsizes: 324  
Outpatient Pharmacy: Yes

## **Norman Regional Hospital Booth #1101**

Norman, OK  
Barbara Miles Poe, DPh, MBA, FASHP  
Pharmacy Manager  
Bedsizes: 382



# PROVIDER ATTENDEES LIST BY FACILITY



## **North Shore University Hospital Booth #609**

Manhasset, NY  
Onisis Stefas, PharmD, MBA  
Senior Director of Pharmacy  
Bedsize: 812  
Outpatient Pharmacy: Yes

## **NorthBay Medical Center Booth #211**

Fairfield, CA  
Jerry Gonzales, Pharm D  
Director  
Bedsize: 182

## **Northeast Georgia Health System Booth #1015**

Gainesville, GA  
Stephen Carlson, MHA  
Director of Pharmacy  
Bedsize: 557  
Outpatient Pharmacy: Yes

## **Northern Arizona Health Booth #314**

Flagstaff, AZ  
Richard Mendribil, PharmD  
Health System Director of Pharmacy  
Bedsize: 400  
Outpatient Pharmacy: Yes

## **Northern Hospital of Surry Co. Booth #809**

Mount Airy, NC  
W. Darrell Estes, BS, PharmD  
Director of Pharmacy  
Bedsize: 134  
Outpatient Pharmacy: Yes

## **Northridge Hospital Medical Center Booth #221**

Northridge, CA  
Blair W. Galbreath, PharmD  
Director of Pharmacy  
Bedsize: 411

## **Novation Booth #1000**

Irving, TX  
Leslie Larsen  
Portfolio Executive

## **Novation Booth #1001**

Irving, TX  
Steve Rudner, MS, PharmD  
Portfolio Executive

## **Nyack Hospital Booth #610**

Nyack, NY  
Joe Pinto  
Director of Pharmacy Services  
Bedsize: 375

## **NYU Langone Medical Center Booth #611**

New York, NY  
Arash Dabestani, PharmD, MHA, FASHP, FABC  
Senior Director of Pharmacy  
Bedsize: 1000  
Outpatient Pharmacy: Yes

## **Oak Hill Hospital Booth #1018**

Brooksville, FL  
Michael Jackson, PharmD  
Director of Pharmacy  
Bedsize: 262

## **Oakwood Hospital and Medical Center Booth #512**

Dearborn, MI  
David Batkie, RPh, MBA  
Director of Pharmacy  
Bedsize: 600  
Outpatient Pharmacy: Yes

## **Oakwood Hospital and Medical Center Booth #510**

Dearborn, MI  
Eric Munson, PharmD  
Manager  
Bedsize: 625

## **Olive View - UCLA Medical Center Booth #210**

Sylmar, CA  
Steve Lee  
Director of Pharmacy  
Bedsize: 377  
Outpatient Pharmacy: Yes

## **Olympia Medical Center Booth #209**

Los Angeles, CA  
Annette Marquez  
Director of Pharmacy  
Bedsize: 204

## **Oro Valley Hospital Booth #315**

Oro Valley, AZ  
Mike Zoucha  
Director of Pharmacy  
Bedsize: 146

## **Oroville Hospital Booth #208**

Oroville, CA  
Daniel Nguyen  
Director of Pharmacy  
Bedsize: 153

## **Pacific Hospital of Long Beach Booth #207**

Long Beach, CA  
Ken Fukushima  
Director of Pharmacy  
Bedsize: 184

## **Park Ridge Hospital (Adventist Health Sys) Booth #1201**

Hendersonville, NC  
Susan Hoy, RPh, MBA  
Director of Pharmacy  
Bedsize: 103

## **PDM Healthcare Booth #511**

Cleveland, OH  
Ash Chawla  
President/CEO

## **PDM Healthcare Booth #511**

Cleveland, OH  
Irene Jurca  
Vice President

## **PDM Healthcare Booth #511**

Cleveland, OH  
Tony Viridi  
Director, Contracts & Sales Administration

## **Phelps County Regional Medical Center Booth #404**

Rolla, MO  
Kreig L. Moore, RPh  
Director of Pharmacy Services  
Bedsize: 242  
Outpatient Pharmacy: Yes

## **Ponca City Medical Center Booth #1102**

Ponca City, OK  
Rick McCumber, MBA, DPh  
Director of Pharmacy  
Bedsize: 130  
Outpatient Pharmacy: Yes

# PROVIDER ATTENDEES LIST BY FACILITY



## **Premier Inc. (Catholic Contracting Group) Booth #709**

Charlotte, NC  
Michael Maguire  
VP- Member Field Services

## **Presence Saint Joseph Medical Center Booth #420**

Joliet, IL  
Se H. Choi, PharmD  
Director of Pharmacy Services  
Bedsize: 480

## **Promise Healthcare Booth #1207**

Boca Raton, FL  
Nish Patel, PharmD  
VP, Corporate Pharmacy Operations  
Bedsize: 950

## **Providence Holy Cross Medical Center Booth #215**

Mission Hills, CA  
Tawny Bui, PharmD  
Director of Pharmacy  
Bedsize: 377  
Outpatient Pharmacy: Yes

## **Raritan Bay Medical Centers Booth #717**

Perth Amboy, NJ  
Craig Dolan, RPh, PharmD  
Sr. Dir. of Pharmacy, Respiratory and Sleep  
Bedsize: 501

## **Regional Medical Center Bayonet Point Booth #1019**

Hudson, FL  
Kriston L. Bottrell, BS Pharm, CPh  
Director of Pharmacy  
Bedsize: 290

## **Resolute Health Booth #901**

New Braunfels, TX  
Stewart Wirebaugh, PharmD, FASHP  
Director of Pharmacy Services  
Bedsize: 128  
Outpatient Pharmacy: Yes

## **Retreat Doctors' Hospital Booth #704**

Richmond, VA  
Jennifer Hill  
Pharmacy Director  
Bedsize: 227  
Outpatient Pharmacy: Yes

## **Robert Wood Johnson University Hospital Booth #716**

Hamilton, NJ  
Alex Kardos, RPh, BS Pharm  
Director of Pharmacy Services  
Bedsize: 160

## **Roger Williams Medical Center Booth #617**

Providence, RI  
James Joseph Melfi, RPh, PharmD, PhD  
Director of Pharmacy  
Bedsize: 220  
Outpatient Pharmacy: Yes

## **ROi**

**Booth #407**  
St. Louis, MO  
Jill Webb  
Senior Contract Manager - Pharmacy  
Bedsize: 7555

## **Saddleback Memorial Medical Center Booth #206**

Laguna Hills, CA  
Kathleen Cross, PharmD, MBA  
Director of Pharmacy Services  
Bedsize: 352  
Outpatient Pharmacy: Yes

## **Saint Francis Health System Booth #1103**

Tulsa, OK  
George Ronald Kolar, DPh, MS, FASHP  
System Director of Pharmacy Services  
Bedsize: 970

## **Saint Francis Medical Center Booth #715**

Trenton, NJ  
Joseph Latini  
Director of Pharmacy  
Bedsize: 235

## **Salinas Valley Memorial Hospital Booth #205**

Salinas, CA  
Larry Dolph, PharmD  
Director of Pharmacy  
Bedsize: 269

## **Samaritan Healthcare Booth #101**

Moses Lake, WA  
Lloyd Stever, PharmD  
Director of Pharmacy  
Bedsize: 50

## **San Gabriel Valley Medical Center Booth #119**

San Gabriel, CA  
Steve Dohi  
Director of Pharmacy & Diagnostic Imaging  
Bedsize: 273

## **Scripps Health Booth #204**

San Diego, CA  
Mark Parmenter  
System Director, Clinical Pharmacy Services  
Bedsize: 1000  
Outpatient Pharmacy: Yes

## **Scripps Health Booth #203**

San Diego, CA  
Kenneth Scott  
Executive Director of Pharmacy  
Bedsize: 1000  
Outpatient Pharmacy: Yes

## **Sentara Healthcare Booth #703**

Norfolk, VA  
Edwin L. Gutshall, PharmD  
Pharmacy Business Manager  
Bedsize: 2000

## **Seton Medical Center Booth #301**

Daly City, CA  
Martha Yasavolian  
Director of Pharmacy  
Bedsize: 478

## **Sharp Grossmont Hospital Booth #202**

La Mesa, CA  
Hoangmy Nguyen, PharmD  
Director of Pharmacy  
Bedsize: 536  
Outpatient Pharmacy: Yes

## **Sharp Memorial Hospital - San Diego Booth #201**

San Diego, CA  
Shannon John Johnson, PharmD  
Pharmacy Director  
Bedsize: 341

## **Shore Memorial Hospital Booth #714**

Somers Point, NJ  
Matthew Piskun, PharmD  
Pharm Director/PGY1 Director  
Bedsize: 299

# What's Your Repackaging Strategy?

Consider The Better Alternative to In-House Packaging

Buy commercial  
unit-dose

Outsourced  
repackaging partner

In-house  
(only what I have to)

## Upcoming Deadlines:

- BCMA
- Meaningful use dollars

## Repackaging Issues to solve

- Regulatory requirements
- Barcode expertise
- ED/OPD Prepacks
- Oral Liquids
- Pediatric oral syringes
- 340B
- RFID
- Controlled substances

I need help!  
Who's the expert?  
Safecor Health.

- Not our core competency
- Staffing issues
- Space
- Packaging errors

## What are my goals?

- ↓ Cost (strong ROI)
- ↑ Quality/  
Medication Safety
- ↓ Errors
- Implement Quickly

Contact Us Today For More Information  
800.447.1006 • Email: [sales@safecorhealth.com](mailto:sales@safecorhealth.com)

**SAFECOR**  
HEALTH



# *Committed to the ever-changing world of cancer care*

Teva Oncology, a top 10 oncology company in the US,<sup>\*1</sup> offers multiple therapies for hematologic malignancies and has an approved product for supportive cancer care.

Our diverse pipeline of compounds and biologics holds great promise for future therapies in hematologic malignancies, solid tumors, and supportive care. By combining our global heritage with therapeutic innovation, we provide more treatment choices for patients with cancer.

**Explore the depth of Teva Oncology.  
Visit [TevaOncology.com](http://TevaOncology.com)**

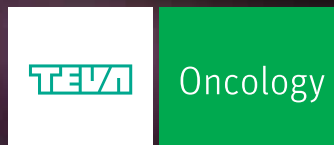

<sup>\*</sup>Excluding supportive care.

**Reference: 1.** EvaluatePharma®, March 2013.

©2013 Cephalon, Inc., a wholly owned subsidiary of Teva Pharmaceutical Industries Ltd. All rights reserved. ONC-40170 April 2013. Printed in USA.

# PROVIDER ATTENDEES LIST BY FACILITY



## **Somerset Medical Center**

**Booth #713**  
Somerville, NJ  
Stuart Vigdor, RPh  
Director of Pharmacy  
*Bedsizes: 355*

## **Southern Hills Hospital**

**Booth #318**  
Las Vegas, NV  
Daniel Kim, RPh  
Director of Pharmacy Services  
*Bedsizes: 140*

## **St. Lukes Hospital at The Vintage**

**Booth #900**  
Houston, TX  
Jerry King, RPh, MBA  
Director of Pharmacy  
*Bedsizes: 94*

## **St. Barnabas Hospital**

**Booth #612**  
Bronx, NY  
Ruth E. Cassidy, PharmD  
Assistant Vice President  
*Bedsizes: 660*

## **St. Cloud Hospital (CentraCare Health Sys)**

**Booth #413**  
St. Cloud, MN  
Mary Voelker Phipps, PharmD  
Director of Pharmacy  
*Bedsizes: 489*  
*Outpatient Pharmacy: Yes*

## **St. Dominic Hospital**

**Booth #1007**  
Jackson, MS  
Mary Helen Bowen  
Assistant VP, Pharmacy Services  
*Bedsizes: 536*  
*Outpatient Pharmacy: Yes*

## **St. Elizabeth Hospital**

**Booth #1006**  
Gonzales, LA  
Tammy Belleau, RPh  
Director of Pharmacy  
*Bedsizes: 78*

## **St. Francis Hospital, Inc.**

**Booth #1016**  
Columbus, GA  
John J. Drew, III, PharmD  
DOP  
*Bedsizes: 376*

## **St. Francis Medical Center**

**Booth #302**  
Lynwood, CA  
Gerald E. Boden, PharmD  
Senior Director, Professional Svcs  
*Bedsizes: 384*

## **St. John Hospital & Medical Ctr (Ascension)**

**Booth #424**  
Detroit, MI  
Kevin Dubay  
Mgr, Operations Department of Pharmacy Svcs  
*Bedsizes: 800*

## **St. John's Regional Medical Center**

**Booth #200**  
Oxnard, CA  
Richard Carvotta, RPh, MBA  
Director, Pharmacy  
*Bedsizes: 266*

## **St. John's Health Center**

**Booth #300**  
Santa Monica, CA  
John Lee, PharmD  
DOP  
*Bedsizes: 235*

## **St. Jude Children's Research**

**Booth #820**  
Memphis, TN  
Bruce Warren  
Director of Pharmacy  
*Bedsizes: 62*  
*Outpatient Pharmacy: Yes*

## **St. Louise Regional Hospital**

**Booth #303**  
Gilroy, CA  
Norman Fox, Pharm. D., MS  
Pharmacy Director  
*Bedsizes: 93*  
*Outpatient Pharmacy: Yes*

## **St. Luke's Hospital at the Vintage**

**Booth #1003**  
Houston, TX  
Al Estrada, RPh, MS  
Regional Director  
*Bedsizes: 208*

## **St. Mary - Corwin Medical Center**

**Booth #311**  
Pueblo, CO  
Ronnie J. Sullivan, RPh, PharmD  
Director of Pharmacy  
*Bedsizes: 408*  
*Outpatient Pharmacy: Yes*

## **St. Mary's Health Care System**

**Booth #1017**  
Athens, GA  
Gary A. Wright, RPh  
Pharmacy Director  
*Bedsizes: 196*

## **St. Rose Dominican Hospital San Martin**

**Booth #224**  
Las Vegas, NV  
Reed J Howe, PharmD  
Pharmacy Director  
*Bedsizes: 266*

## **St. Rose Dominican Hospitals**

**Booth #223**  
Henderson, NV  
Jason Glick  
Director of Pharmacy  
*Bedsizes: 266*

## **St. Vincent Hospital**

**Booth #422**  
Indianapolis, IN  
Alana Washington, PharmD  
Director, Pharmacy Services  
*Bedsizes: 600*

## **St. Vincent Indianapolis Hospital**

**Booth #423**  
Indianapolis, IN  
Anthony Antonopoulos  
Executive Director, Regional Pharmacy Svcs  
*Bedsizes: 625*

## **St. Vincent Med Ctr (Daughters of Charity)**

**Booth #304**  
Los Angeles, CA  
Norman Willis, PharmD  
Director of Pharmacy  
*Bedsizes: 366*

## **Steward Health Care System**

**Booth #616**  
Boston, MA  
Pam Mimms-Cox  
Corporate Pharmacy Director  
*Bedsizes: 2096*

## **Stillwater Medical Center**

**Booth #1104**  
Stillwater, OK  
Bill Arrington, DPh  
Director of Pharmacy  
*Bedsizes: 119*

# PROVIDER ATTENDEES LIST BY FACILITY



## **Summerlin Hospital Medical Center**

### **Booth #319**

Las Vegas, NV  
Steve McMillan  
Director of Pharmacy  
*Bedsizes: 450*

## **Swedish American Hospital**

### **Booth #419**

Rockford, IL  
Thomas Carey, PharmD  
Director of Pharmacy Services  
*Bedsizes: 355*  
*Outpatient Pharmacy: Yes*

## **Texas Health Huguley (Adventist Health)**

### **Booth #1200**

Burleson, TX  
James Hall, RPH  
Director of Pharmacy  
*Bedsizes: 223*

## **Texas Health Presbyterian Hospital Denton**

### **Booth #1004**

Denton, TX  
Rebecca Turner, PharmD, BCPS  
Director of Pharmacy  
*Bedsizes: 250*

## **The Center for Hematology-Oncology**

### **Booth #1023**

Boca Raton, FL  
Sigal Nadulek, RPh, CPh  
Pharmacy Manager  
*Bedsizes: 150*

## **Thomas Hospital**

### **Booth #1012**

Fairhope, AL  
Lisa Wilson Stanley, RPh  
Director of Pharmacy  
*Bedsizes: 150*

## **Tri-City Regional Medical Center**

### **Booth #305**

Hawaiian Gardens, CA  
Martin L. Hesky, PharmD  
Director of Pharmacy  
*Bedsizes: 107*

## **Trinity Medical Center (Community Hlth Sys)**

### **Booth #1010**

Birmingham, AL  
Bettye (Mary) Neuhaus  
Director of Pharmacy  
*Bedsizes: 534*

## **Trinity Mother Frances Hospitals & Clinics**

### **Booth #1005**

Tyler, TX  
Paul Troiano, RPh, MS, FACHE  
Administrative Director of System Pharmacy  
*Bedsizes: 450*  
*Outpatient Pharmacy: Yes*

## **UNC Hospital**

### **Booth #810**

Chapel Hill, NC  
Stephen Eckel  
Associate Director  
*Bedsizes: 803*

## **University of Mississippi Medical Center**

### **Booth #1008**

Jackson, MS  
Michael Todaro, PharmD  
Director of Pharmacy  
*Bedsizes: 722*  
*Outpatient Pharmacy: Yes*

## **Vaughan Regional Medical Center**

### **Booth #1013**

Selma, AL  
Dalton Williamson  
Director of Pharmacy  
*Bedsizes: 175*

## **Virginia Hospital Center**

### **Booth #701**

Arlington, VA  
Michael Nyame-Mireku, PharmD, PhD, MIT, BCNSP  
Assistant Director of Pharmacy  
*Bedsizes: 334*  
*Outpatient Pharmacy: Yes*

## **Wake Forest Baptist Health**

### **Booth #811**

Winston-Salem, NC  
Jason Chou  
System Manager, Distribution Performance  
*Bedsizes: 885*

## **Waukesha Memorial Hospital**

### **Booth #414**

Waukesha, WI  
Virginia Mendoza, BS Pharmacy  
Operations Manager  
*Bedsizes: 285*  
*Outpatient Pharmacy: Yes*

## **West Anaheim Medical Center**

### **Booth #306**

Anaheim, CA  
Darrell Chan, PharmD  
Director Pharmacy Services  
*Bedsizes: 360*

## **White Plains Hospital Center**

### **Booth #613**

White Plains, NY  
Patricia Byrne  
Director of Pharmacy  
*Bedsizes: 292*

## **Williamson Medical Center**

### **Booth #821**

Franklin, TN  
Joanna R. Merritt, DPh, MBA  
Director of Pharmacy  
*Bedsizes: 185*

## **Winchester Medical Center**

### **Booth #700**

Winchester, VA  
Bonnie Pitt, RPh, MAS  
Corporate Director, Pharmacy  
*Bedsizes: 600*

## **Yuma Regional Medical Center**

### **Booth #316**

Yuma, AZ  
Tom Van Hassel, RPh, MPA  
Director of Pharmacy  
*Bedsizes: 369*  
*Outpatient Pharmacy: Yes*



# THANKS TO OUR SPONSORS



## CardinalHealth

Essential to care™

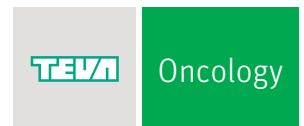

For information on future sponsorship opportunities, please visit Jason Green at the HCP booth in the expo hall.

# Innovative Delivery Solutions

## Find meaningful growth

Top-line impact, such as meaningful growth opportunities, cost savings, reimbursement capture and federal funding

## Fix inefficiencies

Remove operational obstacles and waste, minimize length of stay, optimize spend, and apply Lean strategies

## Fulfill quality care mission

Deliver on the mission of quality care to every patient through core measures, utilization, clinical outcomes, physician alignment and patient satisfaction

## Follow the patient

Patient outcomes and hospital compliance starts at pre-admission and continues post-discharge

### Inpatient and Outpatient Operations

Cardinal Health has over 40 years of expertise in helping healthcare providers align their agenda with pharmacy, thereby successfully institutionalizing the 4Fs to increase quality of patient care and boost financial benefits and patient outcomes.

### Drug Cost Control Solution

We help customers rapidly target the most effective pharmacy cost control efforts and monitor progress, as well as realize improvements in purchasing, formulary management and drug expenditure forecasting.

### CardinalASSIST® ADM Logistics

combines unique packaging and automated medication replenishment with user-friendly reporting to optimize inventory levels with multiple brands of automated dispensing machines (ADM).

### Cardinal Health Distribution

Through our Pharmaceutical Supply Chain business, we consolidate product orders from hundreds of manufacturers into pharmacy-specific deliveries for retail, hospital and alternate-site customers, to more than 33,000 locations.

### Cardinal Health Rx e-source™ Remote Order Entry Service

provides remote medication order entry and review by a hospital-trained pharmacist — anytime, day or night. Prospective pharmacist review not only ensures continuity of care and operational efficiency, it also lets you spend more time with the people who matter most — your patients.

**eRecovery** significantly reduces costs associated with the caring for the uninsured. eRecovery optimizes the value available through patient assistance programs. This means lower costs for hospitals and continued access to life-saving care for the most vulnerable patients.

### Population Health Management

is a patient-centric health management platform that incorporates new models of care coordination to reduce costs, improve outcomes and avoid performance penalties. It uses clinical pathways and actionable analytics to optimize medication management at every member touchpoint, especially for high-risk and chronic individuals.

## Transforming your pharmacy from a cost center to a strategic asset

**Call us today to schedule a Webinar or personal meeting to explore your needs and how we can be of service: 1.877.300.9180**

